

# aClock - a completed time/clock solution

- ✦ We offer you **15% off** if you place your order through PayPal. [purchase](#)
- ✦ aClock has been selected as PalmGear's "**Top 50 Downloads**".

## ■ What Customers Say...

### Average User Rating: ★★★★★ on both PalmGear and Handango

I tested many of the different world clocks available for the Palm and this is my favorite by far. As the description shows there are so many different views and little add ons.

Some world clocks may offer fancier looking pictures as backgrounds, but none are as useful as this entire combination. I have no doubt that this excellent program will continue to improve, though the developer has thought of just about every feature one might want.

**Wayne Chen**

"aClock is a fantastic product as shown by the frequency of feature updates. The developers are without peer when it comes to lightning quick response time to user queries and suggestions. Don't waste your time and money on other pieces of software that allow you to program just a couple of international cities; aClock allows more than 20 city settings. Coupled with aTimer, aStopWatch, aSundial and aDSTKeeper, A0Soft Inc are a highly competent and professional company that offer an excellent suite of applications."

**Dale Kerr**

"This program was great as a standalone, but the plugins he has developed mostly for free make it a brilliant program. The new sundial plugin is really great and it is very nice to be able to store the plugins on my SD card. This is a real bsargain at \$10!!"

**Bill Quinlan**

"I have installed your programs aClock, aSundial and aStop Watch.. and I think they are wonderful. Keep the good work.I like to download and try all the new programs that I can find and I believe these two programs are the best one in their category. They are user friendly, beautiful and informative."

**Fuad Rayess**

"It has a lot of power given the very large selection cities. I like the exchange of home cities which automatically adjusts the system time and the times of all our cities in the list."

**Columbia, MD**

"This aClock is very useful & incredible.I love it. Now without somebody help I can checking the whole world or region time. Especially can avoid sleeping time if I want to contact overseas.Thanks a million. Good job."

**Alan JH Tsai**

"I have been using this program for a while and found the software very useful. I frequently travel and make conference calls globally, this software is clean and simple. It doesn't have the bells and whistles of other software, but it does allow me to schedule calls and see if some other part of the world is awake! Great piece of software and I look forward to further enchnacements!"

**Eric Shen**

and more...

[top](#)

## ■ Features

- Built-in **1170+ cities'** UTC and DST information.
- Shows **23 cities' time** on your Palm. You can also set some cities as blank if you don't want to see so many cities.
- **Changes time at different time zones** without affecting Palm's system time.
- If you are traveling to a different city, the "As Home City" function enables you to **change Palm's system clock based on your destination**.
- **Powerful date calculator** functions. It enables you to calculates the duration between two dates and adds or subtracts days to or from a given date.
- **City name, UTC**(Coordinated Universal Time), **coordinate and DST all are customizable**. You can also add new cities or delete any existing cities to or from the world city database.
- **Supports DST** (Daylight Saving Time) automatically and has flexible DST settings to make any possible DST rule, as defined by your country.
- **Shows the Internet time** and the current time to the **second** on the main screen.
- Enables you to **add notes for each world city**.
- **Sort world cities** by the city name or UTC in ascending or descending order.
- Shows the **latitude** and **longitude** information for each world city.
- Enables you to **change the time with the graffiti input** or page up/down key easily.
- Supports Palm **5-way navigator**.
- Supports Hi-Res (**320x320**).
- Tightly integrated with **aAlarm** and **aDSTKeeper**.
- The intelligent **quick-find** technology enables you to pick a city from the aClock built-in city list easily and quickly.

✦ Click [here](#) to purchase **aClock** now for only US\$10.0 Unregistered user can also have a 15-day to try out all functions.



- With the provided **203 countries database**, you can also **choose a city through a country**.
- aClock supports many **plug-in tools**. E.g. **aTimer** (a countdown timer program), **aStopWatch** (a stopwatch program), **aSundial** (a state-of-the-art analog clock), **aTimeMap** (shows world city times on the world map).
- Enables you to store plug-in tools on the **memory expansion (SD)** card.
- Last but not least, gray-level is supported for your B&W Palm and color is also supported by aClock.

[top](#)

## ■ Supported OSs

- OS v3.2.x (Palm VII)
- OS v3.5.x (Palm IIIc, Vx, m10X)
- OS v4.x (Palm m500, m505, m515)
- OS v5.x
- or later

[top](#)

## ■ How to purchase and register

**aClock** is shareware. Only **US\$10.00** to register. You can purchase **aClock** from the following resale sites.



Now, we offer you **15% off**, if you place your order through PayPal.

[Buy it through PayPal](#)

PayPal is an Internet service which allows you to make the following major credit card payments electronically.



Buy it at [PalmGear](#)

All of our registrations are now handled through the above sites. They maintain a secure server to accept credit cards for all registrations, as well as taking telephone orders if you just don't trust the current state of electronic commerce.

Registering your **aClock** software gets you the benefit of automatic e-mail notification whenever one of the programs you registered is updated, and automatic e-mail notification whenever we release a completely new

product!

Note: Our products are shareware software with a **free trial period**. You do NOT need to order the software to try it out. Only order the software when you are satisfied it will meet your needs as there are no refunds available once you receive your registration code. You will be requested for HotSync user name for registration.

**aClock** v4.0 or later is not a free upgrade version for the users that the registration code starts with **WD-**. We offer a special upgrade option for you to upgrade the old aClock registration code to the latest version. Click [here](#) for details.

[top](#)

■ User's Manual

**aSundial** 1 3 C

8:20:05 pm  
6/1 Sun  
San Francisco

S	M	T	W	T	F	S
1	2	3	4	5	6	7
8	9	10	11	12	13	14
15	16	17	18	19	20	21
22	23	24	25	26	27	28
29	30	1	2	3	4	5
6	7	8	9	10	11	12

June, 2003

**aClock** +@257.7 :13 1 2 T VED

Taipei 9/13 Sa 1:11pm

San Francisco\* 9/12 Fr 10:11pm

Austin\* 9/13 Sa 12:11am

New York\* 9/13 Sa 1:11am

Tokyo 9/13 Sa 2:11pm

Hamburg\* 9/13 Sa 7:11am

Paris\* 9/13 Sa 7:11am

Sydney 9/13 Sa 3:11pm

Reykjavik 8/30 Sa 12:44am

Vancouver\* 8/29 Fr 9:44am

aClock +@258.0 :38 1 2 T VED

Taipei 8/30 Sa 12:44am

San Francisco\* 8/29 Fr 12:44pm

Austin\* 8/29 Fr 11:44am

New York\* 8/29 Fr 12:44pm

Tokyo 8/30 Sa 1:44am

Hamburg\* 8/29 Fr 6:44pm

Paris\* 8/29 Fr 6:44pm

Sydney 8/30 Sa 2:44am

Reykjavik 8/29 Fr 4:44pm

Vancouver\* 8/29 Fr 9:44am

**aTimeMap** :32 M L N

02:59p New Y  
03:59p Qana  
07:59p London  
08:59p Berlin  
03:59a Tokyo  
11:59a San Fr  
03:59p Sao Lu  
01:59p Austin  
08:59p Pretor  
05:59a Sydney

**aTimer**

Cur. Time 02:41:39 pm

Exp. Time 03:01:39 pm

00:20:00

Play Reset Set

**aClock** +@258.3 :59 1 2 T VED

Taipei 8/30 Sa 1:44am

San Francisco\* -15:00

Austin\* -13:00

New York\* -12:00

Tokyo +1:00

Hamburg\* -6:00

Paris\* -6:00

Sydney +2:00

Reykjavik -8:00

Vancouver\* -15:00

**aStopWatch**

Current Time: 09:33:58 pm

No	Time	Lap Time
3	00:00:12.19	00:00:00.62
4	00:00:12.92	00:00:00.73
5	00:00:20.28	00:00:07.36
6	00:00:20.92	00:00:00.64
7	00:00:22.00	00:00:01.08

00:00:22.11

Pause Stop

**Date Calc.** Date Difference

From date: Jan 1, 2000 12:00 am

To date: Today Now

The duration between two dates is:  
238 weeks, 6 days, 17 hours, 37 minutes

Show: Week Day Hour Minute

**Date Calc.** Move Date

From date: Today Now

Add/Subtract:  
+ 0 weeks 100 days  
12 hours 0 mins

The result is:  
Mon Nov 8, 2004  
5:39 am

**Preferences** A aDSTKeeper

☒ auto adjust time for DST

☒ auto update Date & Time panel

Set Date: 4/12/03

Set Time: 4:09 pm

Set Time Zone: San Jose(USA)\*

The daylight saving will end at 2:00 am on 10/26/03

The cur. DST(save 60 min.) period is from 2:00 am, 4/6/03 to 2:00 am, 10/26/03

## Setup the home city and how to change display

### city

**aClock** provides three modes, **View**, **Edit** and **Delta**, for you to see the date/time of world cities in different views. Before using the program, you first have to setup your home city and then setup world cities that you want to see. For how to setup the home city and how to choose a city from the built-in cities list, please see the diagram below.

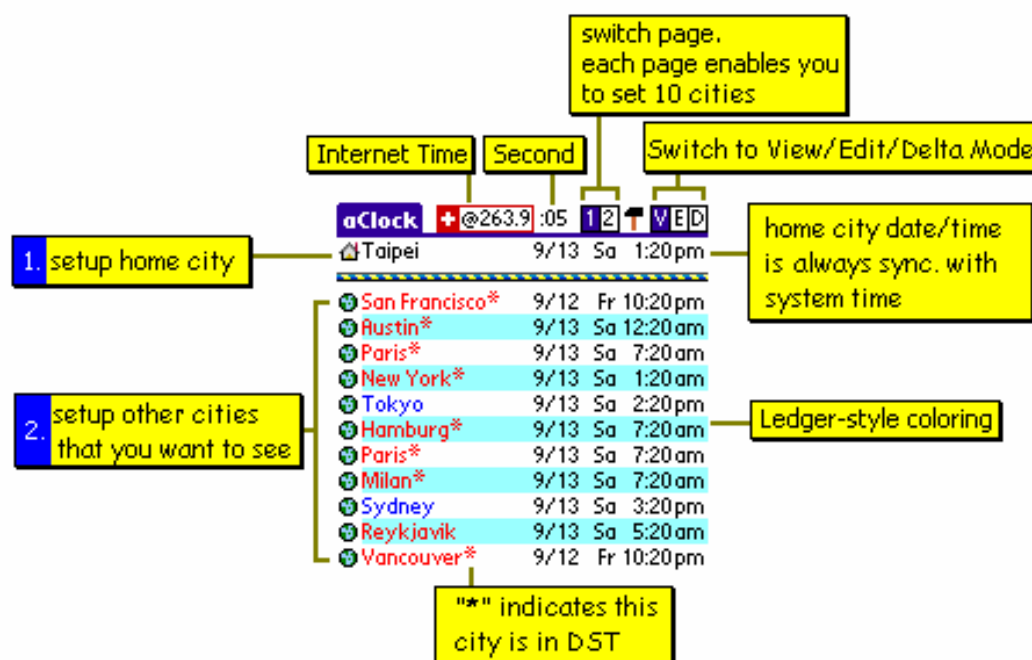

Besides tapping the [V], [E] or [D] button for changing modes, **aClock** also enables you to cycle modes by pressing the Palm application button (hard button). The default setting of this function is disabled. To enable this function, please change the setting from the **Preferences** form. To cycle pages, **aClock** also enables you to do that by pressing the Palm application button (hard button). Please refer to the **Preferences** section for how to change these settings.

Please note that, **aClock** won't change the system clock if you change the home city directly. If you would like **aClock** to change the system clock when you change the home city, please use the **"As Home"** menu function. For details, please refer to the **Use selected city as home city** section.

If you also installed **aAlarm** or **aDSTKeeper**, their home city setting will also be updated when you change the home city in **aClock**. The **"Date & Time"** panel has been added into Palm's **Pref** since Palm OS 4.0, the time zone information will also be maintained in this panel. To change the home city, the time zone information of this panel will also be updated. Please note that, this function will only be enabled if you have installed the **wcCntyDB.pdb** file.

**aClock** also provides a function to classify world cities by country if **wcCntyDB.pdb** is installed on your Palm. You can learn how to choose a city more easily via this function from the following diagram.

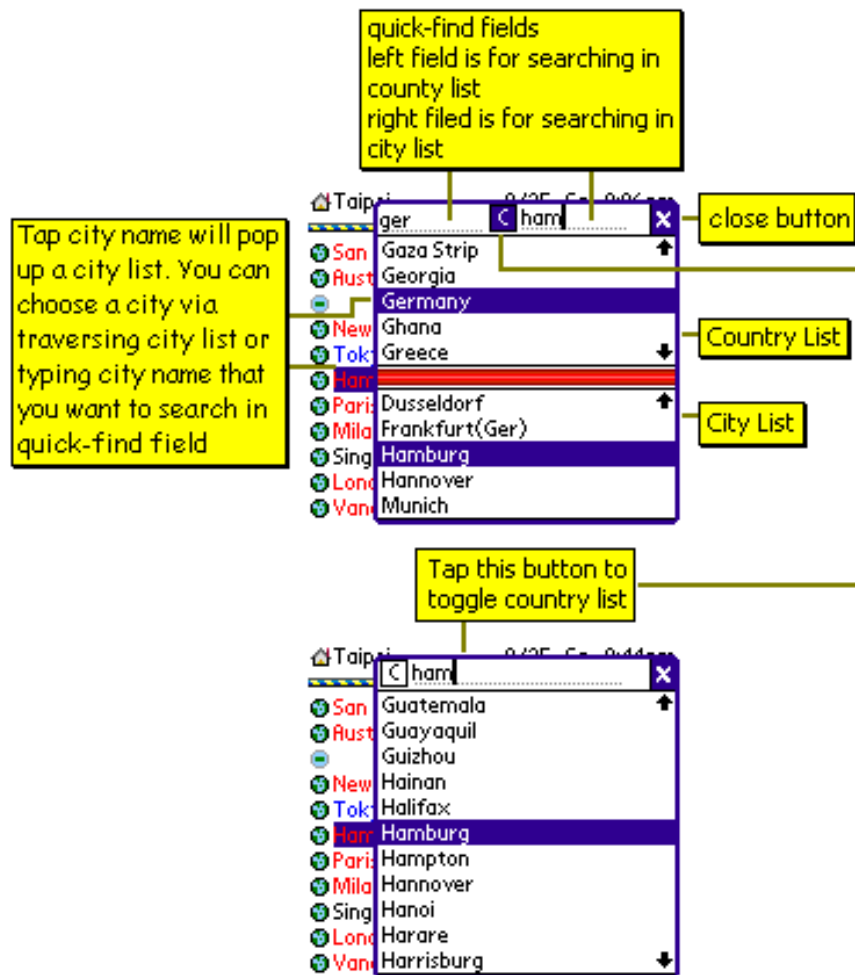

**aClock** will show the city name in **RED** if the local time zone of this city is earlier than the current home city, and shows the city name in **BLUE** if the local time zone of this city is later than the current home time. Please note that this function can only be supported by color enabled Palm machines (e.g. IIIc or m505).

## The Internet Time

The Internet Time is a "new" way to tell time, invented and marketed by the Swiss watch company Swatch. The current Internet Time is the same all over the World (no time zones or daylight saving time adjustments). The Internet Time is based on a new Meridian (as opposed to the Greenwich Meridian). This new Meridian goes through Swatch's office in Biel, Switzerland and is called the BMT Meridian.

Instead of dividing the virtual and real day into 24 hours and 60 minutes per hour, the Internet Time system divides the day into 1000 ".beats". Each .beat is 1 minute and 26.4 seconds.

## Palm 5-way navigator

Palm 5-way navigator is a newly added feature for Tungsten T/W model. **aClock** already supports this for you to operate some functions without using the stylus.

- If no city is selected,
  - **[Select]**: to select the first city.
  - **[Left]**: to select the last city.
  - **[Right]**: to select the first city.
  - hold **[Select]**: to close **aClock** and then return to the **Application Launcher**.
- If any city is selected,
  - **[Select]**: to unselect the current selected city.
  - **[Left]**: to move the selection to the previous city. If the selection reaches the first city, it will change to the previous page and then select the last city.
  - **[Right]**: to move the selection to the next city. If the selection reaches the last city, it will change to the next page and then select the first city.
  - **[Up]**: to move the selected city up for changing the city sequence.
  - **[Down]**: to move the selected city down for changing the city sequence.
  - hold **[Select]**: to close **aClock** and then return to the **Application Launcher**.

## Change the city sequence

If you want to move the selected city up or down for changing the city sequence, you can tap the menu item of **City->Move Up** or **City->Move Down**. Instead of using the menu, you can also press the **Page Up** or **Page Down** hard button for changing the sequence.

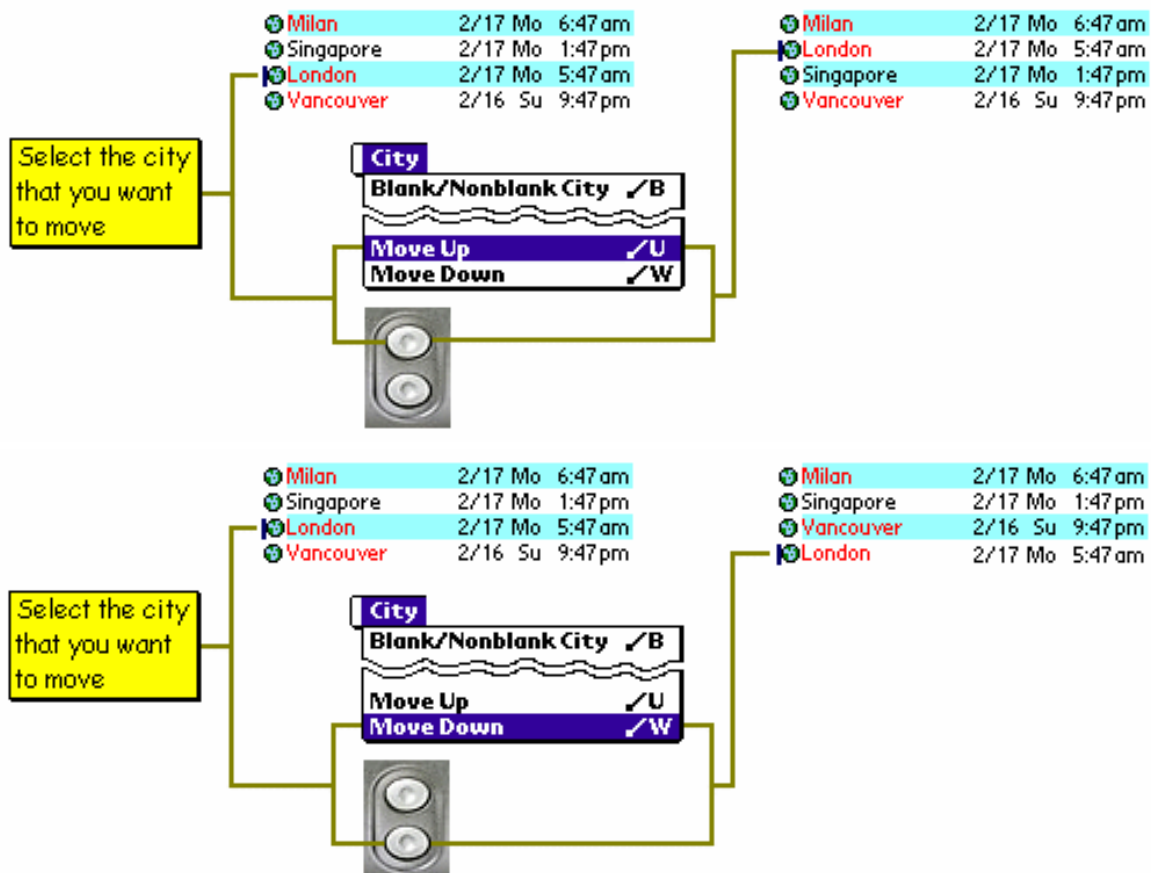



Change the system clock when DST begins or ends

aClock tracks each world city DST period and shows the correct information for you, but aClock is unable to automatically adjust the system clock if the home city DST begins or ends. If you want to do that, you can install our other product, aDSTKeeper (aDSTKeeper is freeware and can be downloaded from <http://www.a0soft.com/>). aDSTKeeper is designed to automatically adjust the Palm system clock when DST begins or ends.

Change the time format (12-hour <-> 24-hour)

By default, aClock shows the date and time according to the format that is defined in the Palm system. If you want to change the display format of dates and times, you can change it from the **Formats** preferences screen that can be invoked by tapping on the **Prefs** icon. For your convenience, aClock also enables you to temporarily change the time display format by directly tapping the time column of the home city in **View** mode.

In View mode, you can tap the time column of home city for changing time format from 12-hour format to 24-hour format

Taipei	8/25	Su	2:16 pm
San Francisco*	8/24	Sa	11:16 pm
Austin*	8/25	Su	1:16 am
Boston*	8/25	Su	2:16 am
New York*	8/25	Su	2:16 am
Tokyo	8/25	Su	3:16 pm
Hamburg*	8/25	Su	8:16 am
Paris*	8/25	Su	8:16 am
Milan*	8/25	Su	8:16 am
Singapore	8/25	Su	2:16 pm
London*	8/25	Su	7:16 am
Vancouver*	8/24	Sa	11:16 pm

Taipei	8/25	Su	14:16
San Francisco*	8/24	Sa	23:16
Austin*	8/25	Su	1:16
Boston*	8/25	Su	2:16
New York*	8/25	Su	2:16
Tokyo	8/25	Su	15:16
Hamburg*	8/25	Su	8:16
Paris*	8/25	Su	8:16
Milan*	8/25	Su	8:16
Singapore	8/25	Su	14:16
London*	8/25	Su	7:16
Vancouver*	8/24	Sa	23:16

Edit Mode

Sometimes, you may want to make an appointment or a conference call with coworkers that are working all over the world. In this case, you can use aClock's **Edit** mode to set the meeting time that you want to call without affecting the system time. For example, you would like to have a conference call at 11:30 am, 1/5 Taipei time with your coworkers who are working in San Francisco and Tokyo. Before you send the meeting notice e-mail, you first need to know the corresponding San Francisco and Tokyo local time. To avoid changing the system time to 11:30 am, 1/5, you can change the Taipei time to 11:30 am, 1/5 with the **Edit** mode function as shown below.



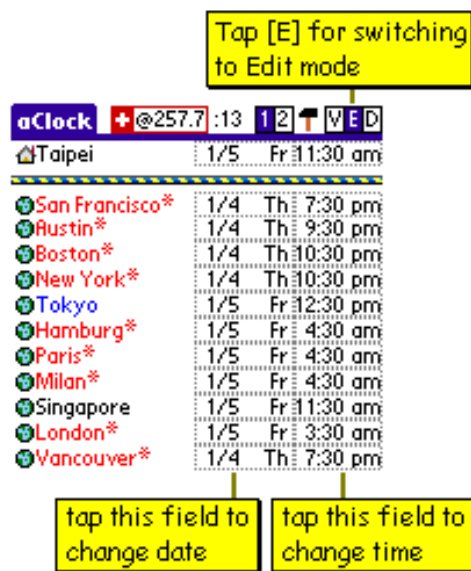

Now, you know that the meeting time for your coworker in San Francisco is 7:30 pm, Thursday, 1/4 and the time for your coworker in Tokyo is 12:30 PM, Friday, 1/5. Of course, you can also set the time from Tokyo's time zone. Last but not least, this **Edit** mode is also DST enabled.

### Set time with the graffiti input or page up/down keys

The Palm system default **Select Time** form only enables you to change the time by tapping the spin box. Sometimes it is a little cumbersome to set a time in this way. **aClock** enables you to change the time not only by tapping the spin box but also the graffiti input or page up/down keys.

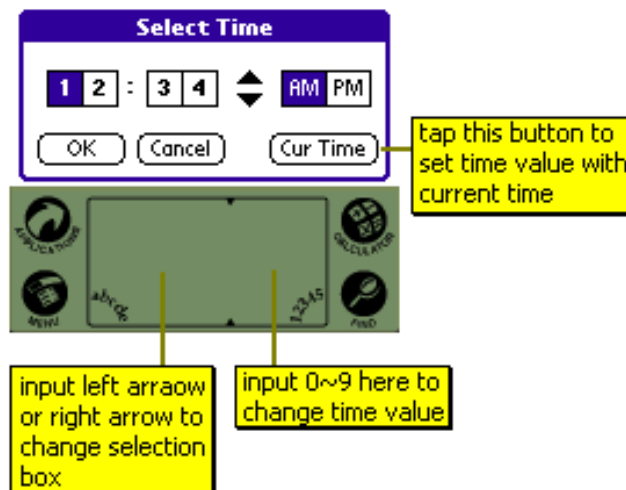

### Delta mode

If you want to know the world cities delta time from the home time, **aClock's Delta** mode is exactly what you want. To switch to this mode, just tap the **D** button on the top-right of the **aClock** main window as shown below.

Tap [D] for switching to Delta mode

<b>aClock</b>	<b>+</b>	<b>@257.7</b>	<b>:13</b>	<b>12</b>	<b>↑</b>	<b>V</b>	<b>E</b>	<b>D</b>
Taipei			8/21 Tu					8:12 pm
San Francisco*								-15:00
Austin*								-13:00
Boston*								-12:00
New York*								-12:00
Tokyo								+1:00
Hamburg*								-6:00
Paris*								-6:00
Milan*								-6:00
Singapore								+0:00
London*								-7:00
Vancouver*								-15:00

## Show UTC time

If you want to show the UTC time, **aClock** also enables you to do that by directly tapping on the time column of the home city in **Delta** mode.

In Delta mode, you can tap the time column of home city for showing current or standard UTC time. Tap to show current UTC and tap again to show standard UTC.

Taipei	8/5 Tu	3:28pm	Taipei	Cur UTC +8:00	Taipei	Std UTC +8:00
Tokyo		+1:00	Tokyo	Cur UTC +9:00	Tokyo	Std UTC +9:00
Paris*		-6:00	Paris*	Cur UTC +2:00	Paris*	Std UTC +1:00
New York*		-12:00	New York*	Cur UTC -4:00	New York*	Std UTC -5:00
Sydney		+2:00	Sydney	Cur UTC +10:00	Sydney	Std UTC +10:00
Singapore		+0:00	Singapore	Cur UTC +8:00	Singapore	Std UTC +8:00
London*		-7:00	London*	Cur UTC +1:00	London*	Std UTC +0:00
Helsinki*		-5:00	Helsinki*	Cur UTC +3:00	Helsinki*	Std UTC +2:00
Berlin*		-6:00	Berlin*	Cur UTC +2:00	Berlin*	Std UTC +1:00
Austin*		-13:00	Austin*	Cur UTC -5:00	Austin*	Std UTC -6:00
Vancouver*		-15:00	Vancouver*	Cur UTC -7:00	Vancouver*	Std UTC -8:00
Baghdad*		-4:00	Baghdad*	Cur UTC +4:00	Baghdad*	Std UTC +3:00

Current UTC = Standard UTC + (DST saving time).

## aClock plug-in tools

We developed some plug-in tools for aClock. Listed here are supported plug-in tools

- [aTimer](#) - a countdown timer program.
- [aStopWatch](#) - a stopwatch program
- [aSundial](#) - a state-of-the-art analog clock.

- [aTimeMap](#) - show world city times on the world map.

Most of the plug-in tools are freeware. You can download them from <http://www.a0soft.com>. You can invoke these plug-in tools from **aClock** as shown below.

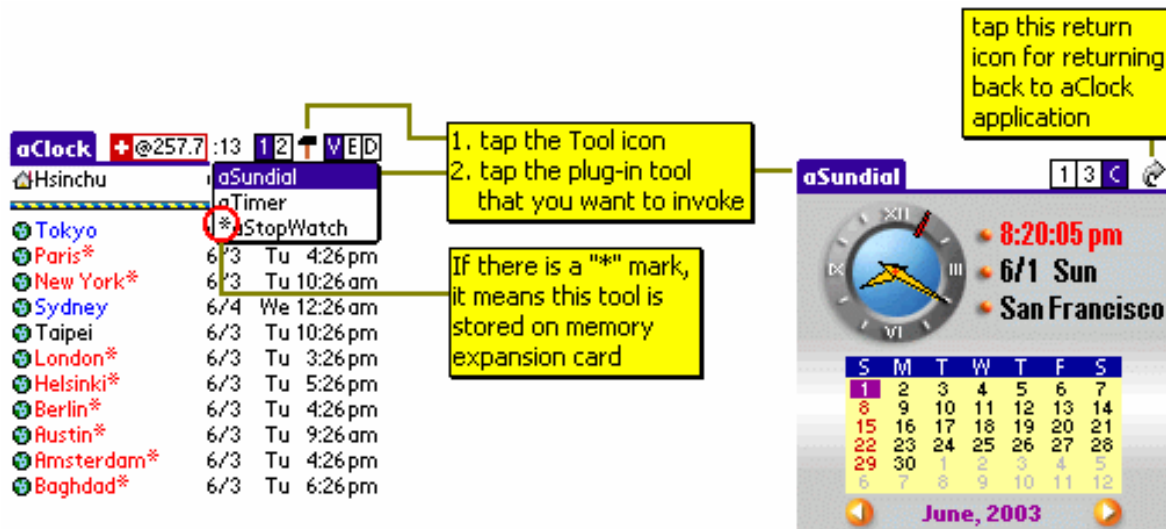

If you switch to the other application from **aClock** while the plug-in tool is running, **aClock** will remember the last invoked plug-in tool. That means if you tap the **aClock** icon, **aClock** will automatically invoke the last running plug-in tool for you. For saving the main memory, you can also store plug-in tools on the memory expansion (SD) card. Once you have installed the plug-in tools in the main memory, you can then use a file management tool like FileZ (<http://www.nosleep.net/>) to move the plug-in tools main programs from the main memory into **/PALM/Programs/A0Soft** directory.

### Select a city and set it as blank

If you only want to keep track of 5 world cities, because showing 12 cities may distract you, you can set useless cities as blank to help you track world city times clearly. You can also use this function to separate different city groups. To undo the blank, you can execute this function again. For how to use this function, please see the following diagram.

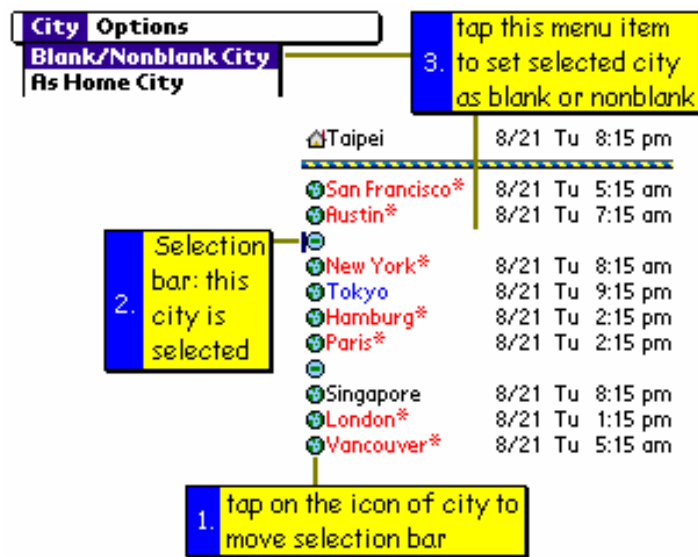

### Use selected city as home city

When you are traveling a lot, and need to keep changing your system time settings for different airports and cities. And it's necessary to change your system time to make sure your alarms and appointments for that particular location work. It would be easier if a tool could change the system time based on your destination. **aClock's "As Home"** function is designed for this purpose. For example, if you are traveling to New York from Taipei and would like to set alarms and appointments based on the New York local time instead of the Taipei time, you can select New York city first, and then execute the "**As Home**" function to set New York as the home city and Palm's system time will also be changed to the current time of New York as shown below.



After you changed the home city, you can set your alarms or appointments based on New York time.

If you also installed **aAlarm** or **aDSTKeeper**, their home city settings will also be updated, too. The "**Date & Time**" panel has been added into Palm's **Pref** since Palm OS 4.0, the time zone information will also be maintained in this panel. To use **aClock's "As Home"** function, the time zone information of this panel will also be updated, too. **Please note that, this function will only be enabled if you have installed the **wcCntyDB.pdb** file.**

### Edit Note

If you want to keep the city related information, e.g.. country code, area code, international code and currency exchange rate, with the city, you now can achieve that via **aClock's** Edit Note function. To add notes for a city, you have to select a city, and then tap the "**Edit Note...**" menu or the note icon. **aClock** will display a form for you to

add notes for the selected city. Currently, the maximum note size is 1024 characters.

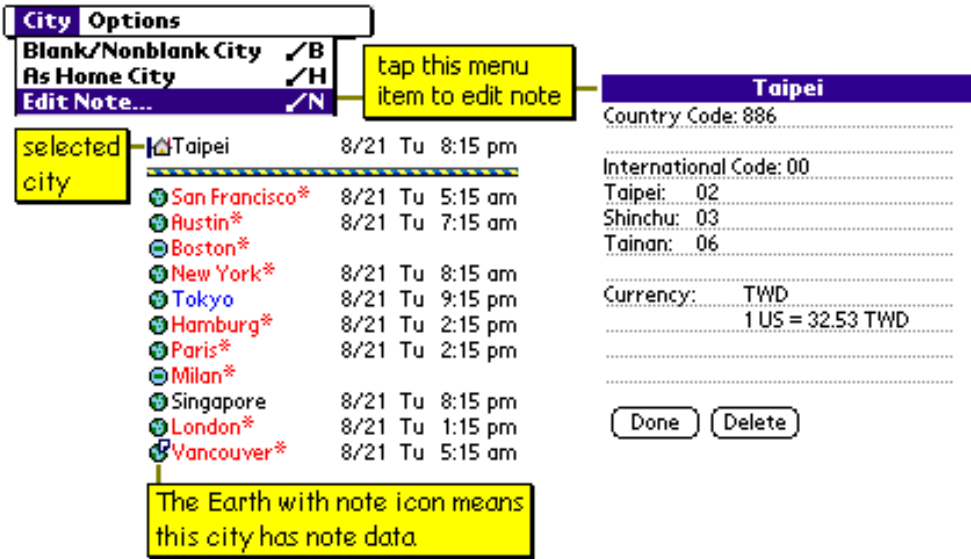

## Sort cities

The sort function enables you to sort current display world cities by the city Name, UTC or current Time in either ascending or descending order.

For the blank cities, you have three options to decide how to handle them. The "**sort it too**" option will sort the blank cities as well. The "**put it at the top**" option will put all blank cities at the top of display cities list. And, the "**put it at the bottom**" option will put blank cities at the end of display cities list.

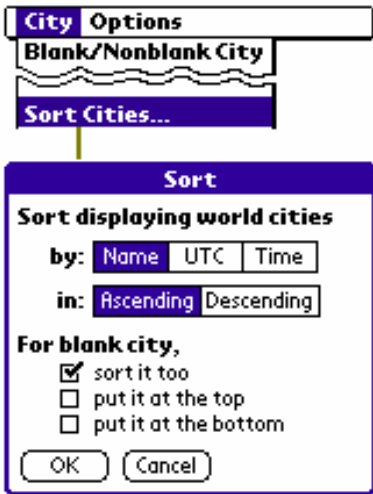

If some cities are on DST and some are not, the sort by time function enables you to sort cities by actual time. The sort by UTC function is to sort cities by the standard UTC information. The sorting result won't be affected by DST being on or off.

## City details information

The **Details...** function shows detailed information about the current selected city.

City Options

Blank/Nonblank City ✓B

Details...

select the city that you want to see

Taipei	8/25	Su	15:04
San Francisco*	8/25	Su	0:04
Austin*	8/25	Su	2:04
Boston*	8/25	Su	3:04
New York*	8/25	Su	3:04
Tokyo	8/25	Su	16:04
Hamburg*	8/25	Su	9:04
Paris*	8/25	Su	9:04
Milan*	8/25	Su	9:04
Singapore	8/25	Su	15:04
London*	8/25	Su	8:04
Vancouver*	8/25	Su	0:04

tap this menu item for showing the detail of a city

City Details

City: New York\*

Country: USA, New York

Cur. time: 3:04 am, Sun 8/25/02

Std. time zone: UTC-5:00 hours

DST adjustment: +1:00 hours

Cur. time zone: UTC-4:00 hours

DST: the current DST period is from 2:00 am, Sun 4/7/02 to 2:00 am, Sun 10/27/02

Coord: 40:44 North, 73:55 West

Close

Date Calculator

You can invoke the date calculator by tap on the **Options -> Date Calc** menu command.

There are two functions provided by the date calculator, Date Difference and Move Date. The first one function enable you to calculate the duration between two dates and the second function enables you to add or subtract days to or from a given date.

Date Difference

Move Date

Date Calc.

▼ Date Difference

From date: Today Now

To date: Today Now

The duration between two dates is: 0 weeks

Show: Week Day Hour Minute

Close

Date Calc.

▼ Move Date

From date: Today Now

Add/Subtract: + 0 weeks 0 days 0 hours 0 mins

The result is: Fri Jul 30, 2004 5:48 pm

Close

Select Time

05 : 50 AM PM

OK Cancel Now

Select Date

◀ 2004 ▶

Jan	Feb	Mar	Apr	May	Jun
Jul	Aug	Sep	Oct	Nov	Dec
S	M	T	W	T	F
				1	2
4	5	6	7	8	9
11	12	13	14	15	16
18	19	20	21	22	23
25	26	27	28	29	30
					31

Cancel Today

The following diagram shows you how to use the Date Difference function to calculate the duration between Jan. 1, 2000 and now. You can use the Show: field to change the display format.

Date Calc.▼ Date Difference

From date:

Jul 1, 200012:00 am

To date:

TodayNow

The duration between two dates is:

212 weeks, 6 days, 17 hours, 52 minutes

Show:

WeekDayHourMinute

Close

Date Calc.▼ Date Difference

From date:

Jul 1, 200012:00 am

To date:

TodayNow

The duration between two dates is:

1490 days, 17.8833 hours

Show:

WeekDayHourMinute

Close

Date Calc.▼ Date Difference

From date:

Jul 1, 200012:00 am

To date:

TodayNow

The duration between two dates is:

1490.7444 days

Show:

WeekDayHourMinute

Close

If you'd like to know which day it is in 600 days, the Move Date function is designed for this purpose. If you'd like to know the date 600 days before, you can tap on the "+" to subtract the date.

Date Calc.▼ Move Date

From date:

Jul 20, 2004Now

Add/Subtract:

+

0

weeks

600

days

0

hours

0

mins

The result is:

Sun Mar 12, 20065:55 pm

Close

Date Calc.▼ Move Date

From date:

Jul 20, 2004Now

Add/Subtract:

0

weeks

600

days

0

hours

0

mins

The result is:

Thu Nov 28, 20025:55 pm

Close

Because Palm's system limitation, the minimum date is 12:00am, Jan. 1, 1904 and the maximum date is 11:59pm, Dec. 31, 2031.

Export date/time to Memo Pad

If you want to export current displaying date and time of world cities to Memo Pad, you can tap on the **City->Send to Memo** menu command.

Edit aClock's city database

Although **aClock** has many built-in world cities, you may still want to modify the city information. For example, changing city name to the local language, changing DST information if the country changes the DST rule, adding a new city that **aClock** didn't list, deleting existing cities for saving the system memory,..., etc. Editing the city database can be done via **aClock** with the provided "**Edit City DB...**" function. Once you have finished the



editing, you can then tap the **"Close"** menu to return to the **aClock** main window.

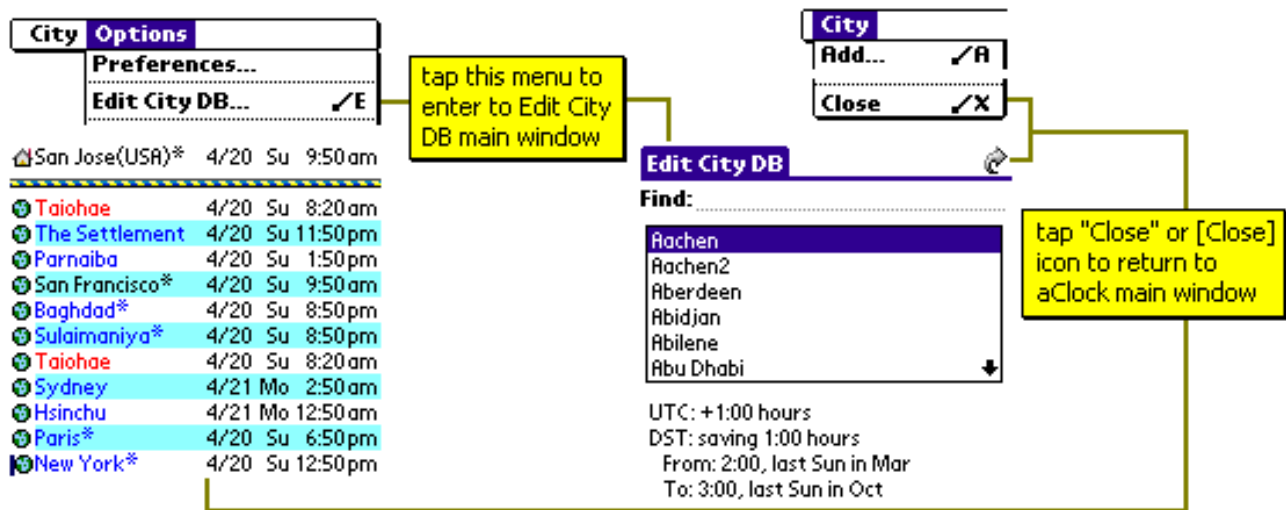

**Modify city**

To modify a city's information, you have to first select the city you want to modify and then tap the **"Modify..."** menu. With this function, you can modify the city name, UTC information and DST information. Please see the diagram below for details.

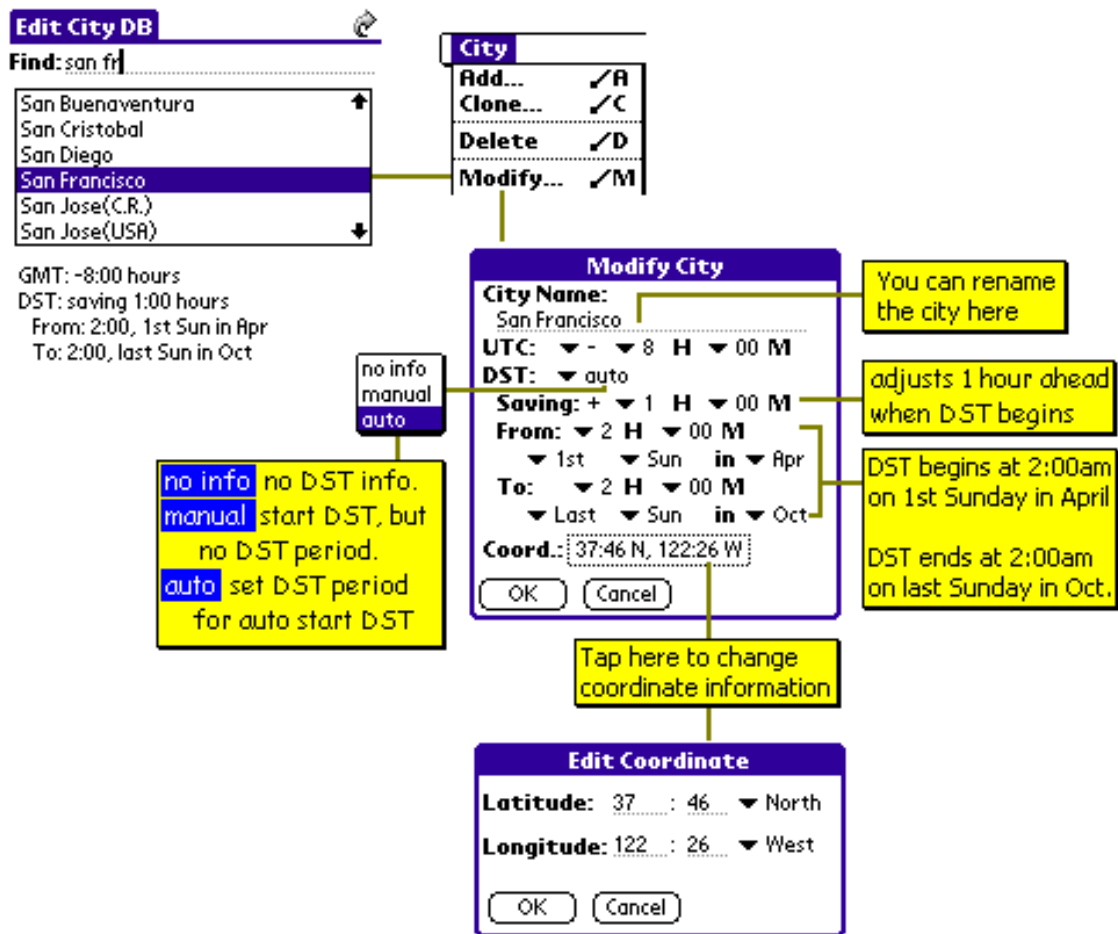

## Add/Clone/Delete city to city database

To add a new city into the world city database, **aClock** will ask you to enter the new city name first. If the new city doesn't exist within the current city database, then **aClock** will add this new city into the database and the default settings of this city will be UTC +0:00 with no DST information. If you want to modify the current settings of this city, you can follow the steps listed in the section above to modify it.

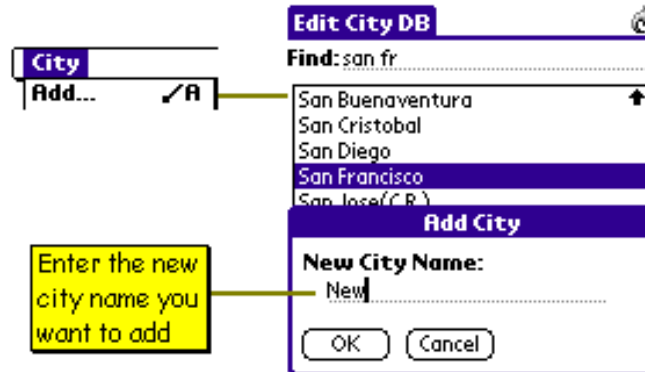

If you would like to clone a new city based on an existent city, you can use the "**Clone...**" function to do that. Please refer to the diagram below for details.

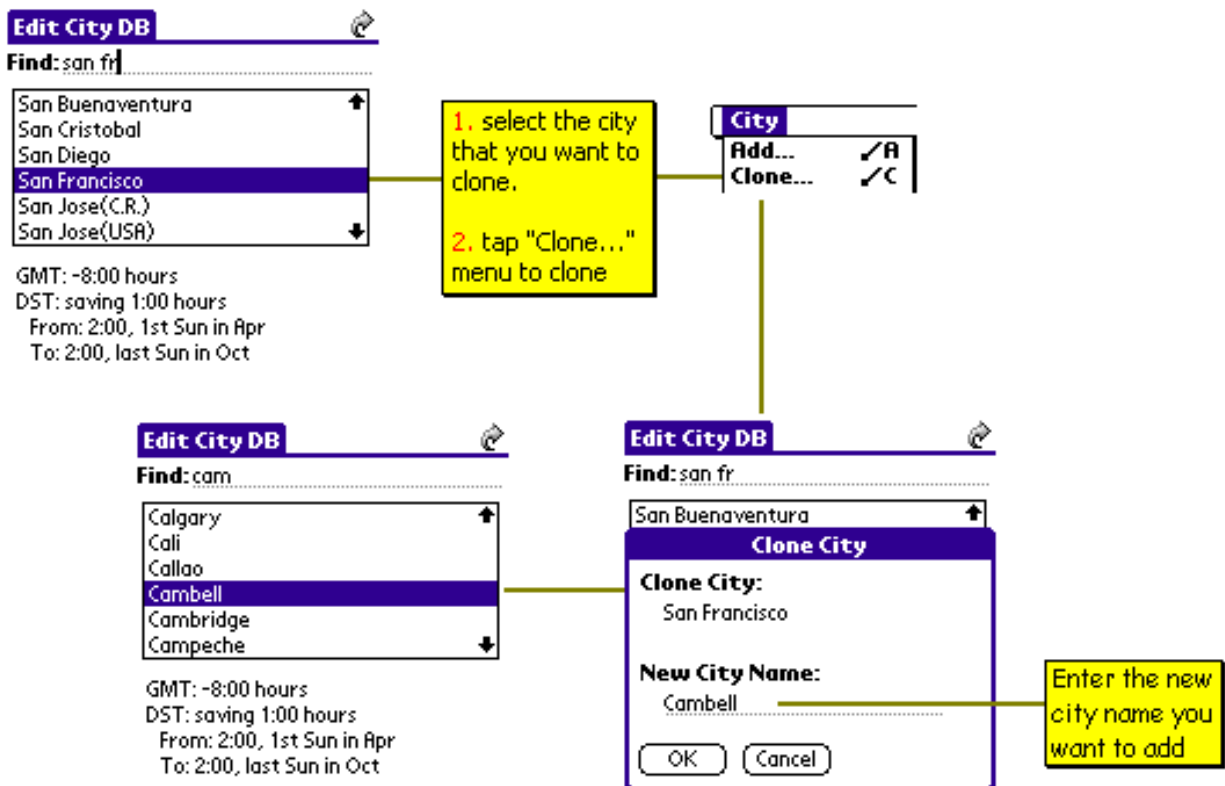

The new cities added by the user will also be saved in the **wcUserCityDB.pdb** database. Whenever you upgrade the world city database, **wcCityDB.pdb**, to the newer version, **aClock** will automatically add cities into **wcCityDB.pdb** according to **wcUserCityDB.pdb**, so cities added by the user will always be maintained. **Please note that, the **wcUserCityDB.pdb** file will also be deleted if you delete **aClock** from Palm. So, please install the new version of **aClock** over the the old when you do an upgrade.**

To delete a city from the database, you have to select the city that you want to delete and then tap the "**Delete...**" menu. Please note that once you have confirmed the deletion, the city will be permanently deleted from the database and it cannot be undone.

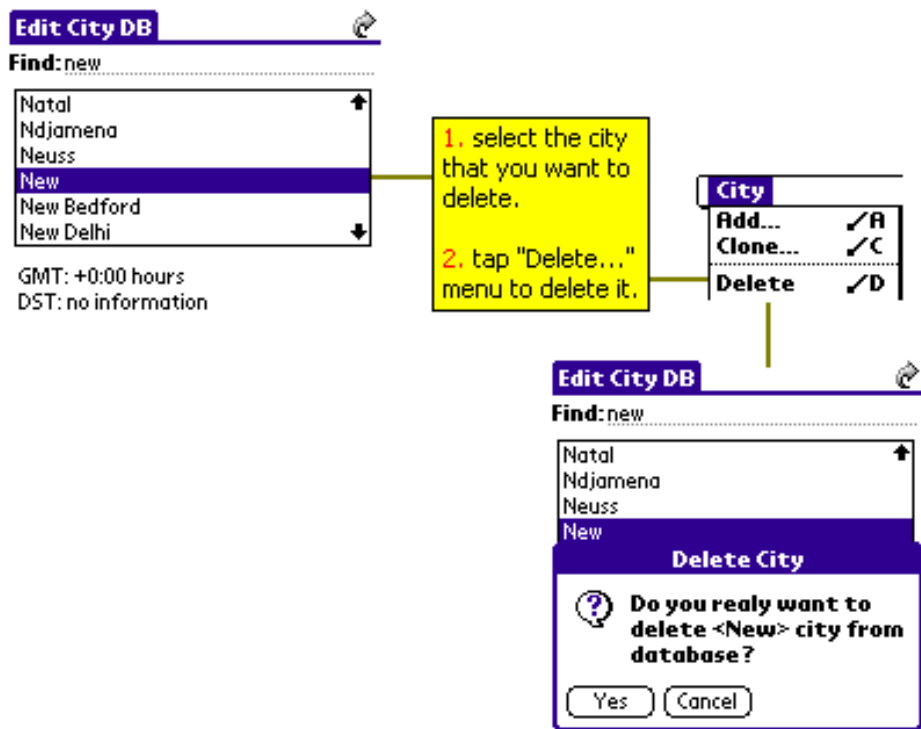

## Preferences

**aClock** enables you to customize default settings of **aClock** via the **Preferences** form. For the detail of this form, please see the diagram below.

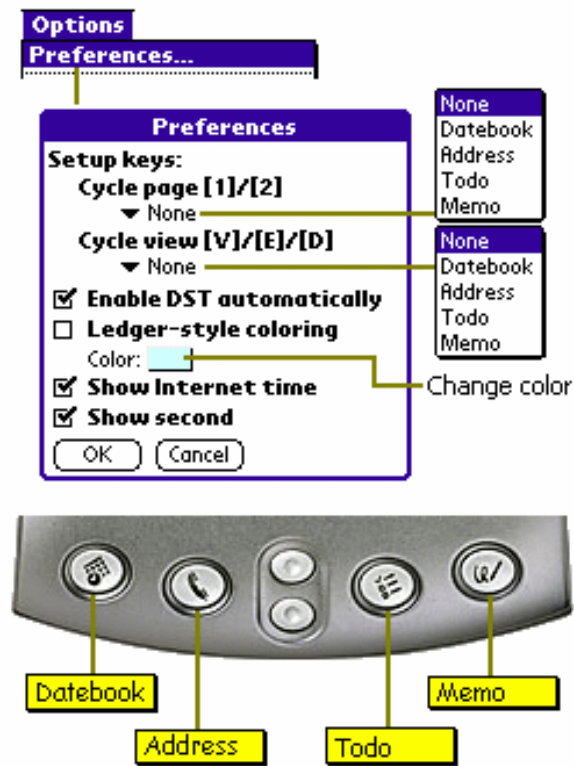

## Set the system clock

**aClock** enables you to set the Palm system clock via **aDSTKeeper** (**aDSTKeeper** is freeware and it can be downloaded from <http://www.a0soft.com/>) or the **Preferences** application.

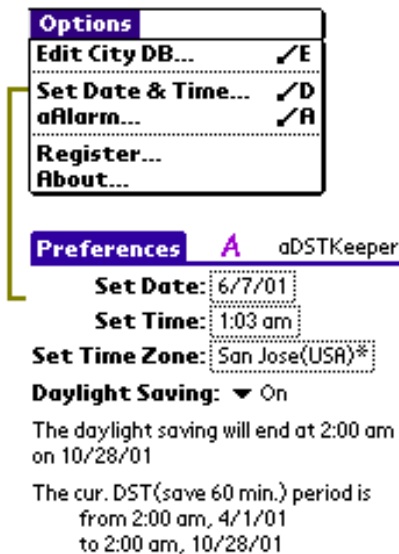

If you have already installed **aAlarm**, you can also directly invoke **aAlarm** through the "**aAlarm...**" menu command.

## Set either B&W or gray-level mode

For non-color Palm users, **aClock** enables you to set either B&W or gray-level mode. Turning on the gray-level mode enables **aClock** to display more colors. **If the default contrast of Palm is too low, please increase the**

contrast to use the gray-level mode. You can switch this mode on or off by the **Gray Level** option box that can be found from the **Options->About...** command.

[top](#)

## ■ To install aClock

1. Start the Palm Install Tool application in your Palm directory or folder.
2. Choose the correct User Name.
3. Choose the **aClock.prc**, **wcCityDB.pdb** and **wcCntyDB.pdb** files that accompanies the downloaded ZIP file.
4. HotSync.

**aClock** is ready to go. Tap on the **Applications** button on your Palm and then tap on the  icon.

If you are upgrading **aClock**, simply install the new version over the old. All your preferences and registration information will be maintained. You do not need to reenter your registration code. **Please note that, aClock v4.0 is not a free upgrade version for users that the registration code starts with "WD-".** Upgrading to **aClock** v4.0 or a later version, please also upgrade your **aAlarm** to v4.0, **aDSTKeeper** to v4.0, and **aSundial** to v2.0.

If you have encountered some problems on upgrading **aClock**, I suggest you then delete the old **aClock** from Palm and then follow the above steps to re-install **aClock**. **To delete aClock from Palm, all aClock preferences and related settings will also be deleted too, so you have to keep your world cities settings and registration codes, if you have them, before deleting.**

For some Palm models, you may also need to use the "Soft Reset" function to reset your Palm after HotSync has completed to make sure the installed program works.

**aClock.prc:** **aClock** main program file.

**wcCityDB.pdb:** world cities database. **aClock** 3.x **wcCityDB.pdb** file format is different with **aClock** 2.x version. If you are an upgraded user, please remember to install this file. Installing this file will overwrite the cities that you modified or the newly added cities via the "**Edit City dB**" function, please save these settings before upgrading. **This file will be used by aClock, aAlarm and aDSTKeeper. If you already installed aAlarm or aDSTKeeper, then this file should already be installed on Palm. Installing this file to your Palm will overwrite the existing world cities information.**

**wcCntyDB.pdb:** is a countries database and is optional. Installing this database if you want to show the country information while choosing a world city. **This file will be used by aClock, aAlarm and aDSTKeeper. If you already installed aAlarm or aDSTKeeper, then this file should already be installed on Palm. Installing this file to your**

Palm will overwrite the existing countries information.

[top](#)

## ■ Removing aClock

If you find that you no longer need **aClock** (or are trying to conserve memory), removing it from your Palm is quite simple. From the Applications launcher :

1. Tap the Menu icon
2. Go to the App menu and choose Delete
3. Select the **aClock** and tap '**Delete...**'
4. At this point you will be asked to confirm your request
5. To do so, tap '**Yes**'. To return to the application launcher tap '**Done**' and confirm that the **aClock** application no longer appears.

PS: To delete **aClock** from Palm, both **wcCityDB.pdb** and **wcCntyDB.pdb** files will also be deleted.

[top](#)

## ■ Release Note

- **4.5 - released on Mar. 15, 2005** [Download 4.5](#)
  - **new** newly updated city and country databases.
- **4.4 - released on Nov. 15, 2004**
  - **new** newly updated city and country databases.
  - **new** added more cities. supported **1196** world cities.
- **4.3 - released on Sep. 1, 2004**
  - **new** exports date/time information of world cities to Memo Pad.
  - **new** calculates the duration between two dates.
  - **new** add or subtract days to or from a given date.
- **4.2 - released on June 1, 2004**
  - **new** newly updated city and country databases.
  - **new** added more cities. support **1178** world cities.
  - ~~bug~~ fixed the clone city function didn't copy all information problem.
- **4.1 - released on May 1, 2004**
  - **new** enables you to put plug-in tools on on multiple memory cards. e.g. UX50.
  - **new** enhanced icons for hi-res/hi-res+ devices.
- **4.0 - released on Dec. 1, 2003**

- **new** enable user to change ledger color.
- **new** options for show/hide the Internet time and current seconds.
- **new** build in coordinate(latitude/longitude) information for each world city.
- **new** shows coordinate in Details form.
- **new** enables you to modify coordinate.
- **new** not only show standard UTC but also current UTC.
- **new** up to date city/country database.
- **new** support OS v3.2 or later.
- **new** support aTimeMap plug-in tool.
- **new** a wizard for user to set up home city for the first time.
- ~~bug~~ fixed Internet time displaying error.
- **3.62 - released on Oct. 1, 2003**
  - **new** show Internet time.
  - **new** show current second number.
  - **new** show UTC instead of GMT
- **3.61 - released on Sep. 1, 2003**
  - **new** new updated city and country database.
  - **new** added more cities. supported **1110** world cities.
- **3.6 - released on July 1, 2003**
  - **new** enables you to store plug-in tools on memory expansion card.
  - **new** new designed application icons.
  - **new** supports Hi-Res (320x320).
  - ~~bug~~ if city name contains special language character, some functions work abnormal on OS v3.x.
- **3.52 - released on May. 1, 2003**
  - **new** new designed "Edit City DB" functions.
  - **new** enhanced "**quick-find**" function
  - ~~bug~~ also delete country DB related information while deleting a city from city DB.
  - ~~bug~~ corrected dirty screen bug when showing Preference form for OS 3.1 or 3.3
  - ~~bug~~ corrected dirty screen bug when showing pulldown menu.
- **3.51 - released on Apr. 1, 2003**
  - **new** new updated city and country database.
  - **new** added more cities. supported **1083** world cities.
  - **new** supported WCDB Open Access APIs.
  - ~~bug~~ corrected Brazil DST infromation.
- **3.5 - released on March. 1, 2003**
  - **new** support Palm Tungsten 5-way navigator.
  - **new** enables you to cycle modes and pages via hard button.
  - **new** new added functions for you to change world city sequence.
  - **new** new added options in Sort function for handling blank cities.
  - **new** new added preferences form for you to customize aClock default behavior.
  - **new** updates time zone settings of "Date & Time" Pref panel if you change home city.
  - **new** user added cities will be maintained whenever you upgrade city database, wcCityDB.db.



- ~~bug~~ disable user to change city if city is blanked.
- **3.42 - released on Jan. 25, 2003**
  - **new** new updated city and country database
  - **new** added standard time zone, e.g. CET, CST,...,etc, into city database.
  - ~~bug~~ corrected Portugal city and country information.
- **3.41 - released on Dec. 18, 2002**
  - ~~bug~~ crash if you click [C] icon on city list form for OS 3.5x users.
  - ~~bug~~ crash if you click [Detail...] menu and without installing wcCntyDB.pdb.
  - ~~bug~~ should show country as blank for those new added cities in city detail form.
- **3.4 - released on Nov. 25, 2002**
  - **new** support Palm OS 5.
  - **new** show standard GMT time in Delta mode.
  - **new** show city detail information.
  - **new** enables you to sort cities by Name, GMT or Time.
  - **new** auto invoke the last running plug-in tool.
  - ~~bug~~ correct sort function unable to handle blank cities problem.
- **3.3 - released on Oct. 12, 2002**
  - **new** built-in more world cities. Now, we already support **1039** cities for **203** countries.
  - ~~bug~~ corrected some cities' incorrect DST or time zone information.
- **3.21 - released on Jun. 16, 2002**
  - ~~bug~~ fix incorrect memory access problems.
- **3.2 - released on Apr. 15, 2002**
  - **new** change product name to **aClock**.
  - **new** support **aClock** plug-in tools and you can directly invoke this kind of tools from **aClock**.
  - ~~bug~~ fix some crash bugs
  - ~~bug~~ fix memory leakage errors
- **3.12 - released on Feb. 8, 2002**
  - **new** enables user to set either B&W or gray level mode for non-color Palm.
- **3.11 - released on Jan. 19, 2002**
  - **new** use less stack memory than 3.0.
  - ~~bug~~ fixed memory bugs for some case.
- **3.1 - released on Dec. 15, 2001**
  - **new** automatically sync. home city name with **WorldAlarm** and **DSTKeeper**
  - **new** enables you to set Palm system clock.
  - **new** enables you to directly invoke **WorldAlarm** from **WorldClock**.
- **3.0 - released on Oct. 1, 2001**
  - **new** built-in more world cities. Now, we already support **724** cities.
  - **new** add country information. built-in **201** countries. To enable you to choose city by country.
  - **new** enables you to display more, up to **23**, cities on your Palm.
  - ~~bug~~ update to date DST information for Mexico.
- **2.2 - released on Jun. 25, 2001**

- **new** support OS 4.0 (m500/m505).
- **new** support gray-level for non-color Palm.
- **new** show different color for different time zone if your Palm is color enabled.
- **new** enable you to change time with graffiti input or page up/down key.
- **new** show success message if **WorldClock** accepts you specified reg. code.
- **2.1 - released on Apr. 30, 2001**
  - **new** new "Edit Note" function allows you to add note for each world cities.
- **2.0.3 - released on Mar. 8, 2001**
  - ~~bug~~ fixed "Fatal Alert" bug while tapping [OK] button of "Edit City dB" form.
  - ~~bug~~ If home city is on DST, the cities delta time will be incorrect.
- **2.0.2 - released on Feb. 24, 2001**
  - **new** change time format between am/pm and 24h by directly tapping on time column of home city.
  - **new** add a new UTC(Universal Time, Coordinated) city into city database.
- **2.0 - released on Jan. 14, 2001**
  - **new** this version only need your HotSync name to generate registration code.
  - **new** new Add/Delete cities functions. Now, you can fully customize WorldClock's world city database.
  - **new** allow you to set any world city as blank.
  - **new** show the delta time of world cities from the home time.
  - **new** allow you to change any world city as home city and update system clock.
  - **new** new sort function to allow you sorting word cities by name or GMT in ascending or descending.
  - **new** new row mode for you to see world cities clock more clear.
  - **new** support Palm's UP/DOWN keys to allow you scroll city list more easily.
  - **new** more intelligent "**quick-find**" function let you choose a city easily and quickly.
  - **new** more built-in cities. WorldClock now has 563 built-in cities.
  - **new** to have a better service, WorldClock need US\$8 for registration fee starts this version.
  - ~~bug~~ fixed hanging problem for some Palm type.
- **1.2 - released on Nov. 25, 2000**
  - **new** color support
  - **new** new animated separator, updated every one second
  - ~~bug~~ fixed flash problem while time is updated
  - ~~bug~~ fixed Washington DC's GMT error, It should be -5 hours instead of +12.  
(Thanks, Blix Patrik, Tom Aronoff)
  - ~~bug~~ should show "12:30 PM" instead of "0:30 PM"  
(Thanks, Ben Goh CK)
- **1.1 - released on Nov. 14, 2000**
  - **new** improved performance when **WorldClock** is starting.
  - **new** also support some Palm devices that didn't has a 12-digit serial number
- **1.0 - first release, released on Nov. 12, 2000**
  - **new** built-in 554 citie

## ■ Appendix

To get latest version, please visit <http://www.a0soft.com>. If you find any incorrect information, please also e-mail your problem to [support@a0soft.com](mailto:support@a0soft.com).